



MAX POWER
1300 W
MAX TORQUE
1000 Nm

Powerful and compact, "10" series air motors can develop more than 1200 W and weigh only 2kg for a 60 mm diameter and a total length that can be as short as 155 mm. This makes it one of the highest power-to-weight ratio air motor on the market.

Available in 4 families (Easy, Standard, Heavy and Super heavy duty) with several types of gearboxes and right angle heads, it can develop up to 1000 Nm torque.

The wide variety of flanges and shafts allows the "10" range air motors to be easily fitted to any machine for a wide range of applications.



+ ACCESSORIES FOR THIS MOTOR	Reference
Filtration, pressure Regulation and Lubrication unit (FRL)	AC107
Safety Air Treatment Box (SAT Box)	AC118
With Pedal remote control	AC119
With handle remote control	AC120
With remote emergency kill switch	AC125
With remote E-Stop and pedal remote control	AC121
With remote E-Stop and handle remote control	AC122
Maintenance kits	
Maintenance kit for "10 XT" series	AC303
Maintenance kit for "10 RV" series	AC308
Maintenance kit for lube free "10 XT" series	AC313
Maintenance kit for lube free "10 RV" series	AC318
Maintenance kit for kit start "10 XT" series	AC323
Maintenance kit for kit start "10 RV" series	AC328
Exhaust collector kit for "10" series	AC340
modec Oil Co-16	AC149
Control handles	
Safety control handle for non reversible "10" series	AC406
Safety control handle for reversible "10" series	AC404
Progressive control handle for non reversible "10" series	AC400
Progressive control handle for reversible "10" series	AC408
Filters and silencers	
Metallic standard silencer	AC182
Metallic standard inlet silencer (RV)	AC181
Plastic standard silencer	AC152
Plastic standard inlet silencer (RV)	AC183
Heavy duty silencer	AC156
Heavy duty inlet silencer (RV)	AC155
High flow air muffler	AC158
Exhaust silencer filter	AC165
Speed control muffler	AC174

CONNECTION AND LUBRICATION				
Min. fittings Ø	Min. pipe Ø		Lubrication [6,2 bars]	
	In	Out		
10 mm / 0,4 In	16 mm / 0,6 In	13 mm / 0,5 In	20 mm / 0,8 In	6 drops / minute

CONVERSION TABLE		
Watt ▶ Horse power	Newton meter ▶ Pound feet	Millimeter ▶ Inch
Watt x 0,001341 = hp	Nm x 0,7376 = lb.ft	mm x 0,03937 = in
Bar ▶ Pound per square Inch	Normo Liter / minute ▶ Standard cubic feet per minute	Kilogram ▶ Pound
Bar x 14,5 = psi	NL / min x 0,03531 = scfm	Kg x 2,205 = lb

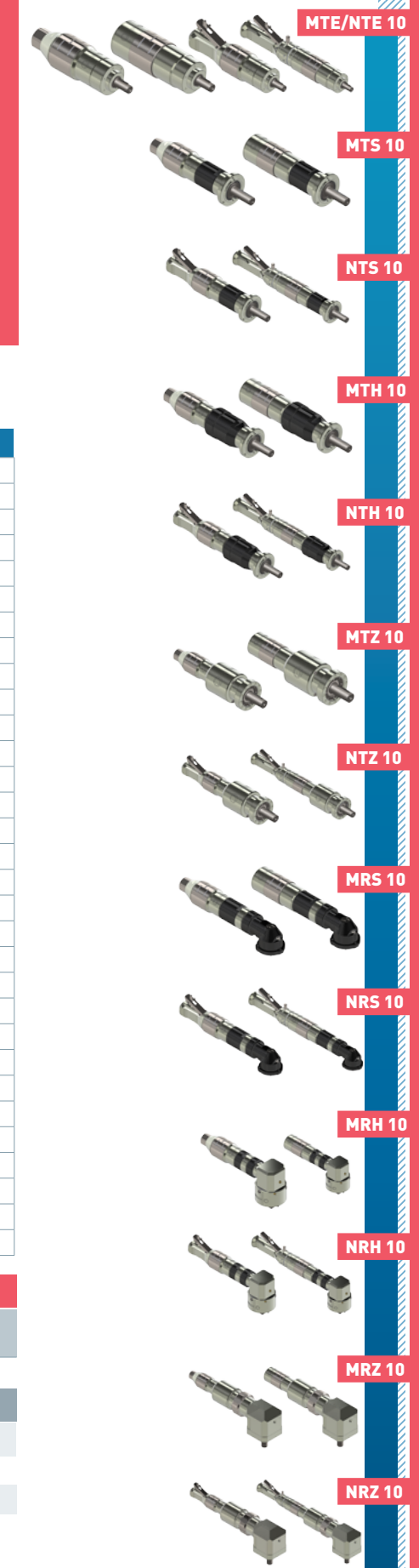

MOTOR MTZ 10

POWER 1100-1250 W

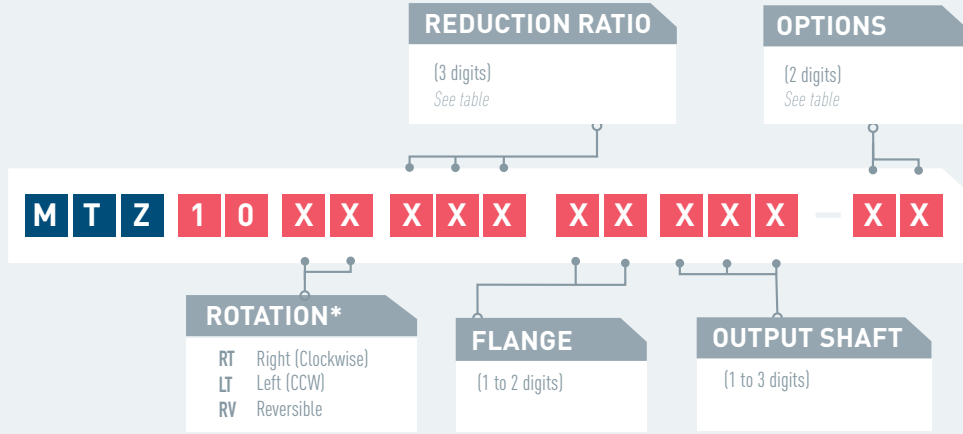

* rotation direction is defined when looking from the back of the motor

PERFORMANCES	MTZ 10 XT												
	Air motor reference	Reduction ratio	Air supply pressure	Speed (rpm)		Torque (N.m)			Max Power (W)	Air cons (Nl/min)	Dimensions		
				@ max Power	Free	@ max Power	Max (stall)	Starting torque			A (mm)	Ø (mm)	Weight (kg)
MTZ 10 XT 169	169	6 bars	44	89	233	338	277	1080	1600	158,2	88,8	4,5	
		5 bars	42	83	186	278	228	810	1200				
		4 bars	39	79	140	224	184	577	1000				
MTZ 10 XT 202	202	6 bars	37	74	279	405	332	1080	1600	158,2	88,8	4,5	
		5 bars	35	69	223	333	273	810	1200				
		4 bars	33	66	167	268	220	577	1000				
MTZ 10 XT 258	258	6 bars	29	58	355	517	424	1080	1600	158,2	88,8	4,5	
		5 bars	27	54	284	424	348	810	1200				
		4 bars	26	52	213	342	280	577	1000				
MTZ 10 XT 309	309	6 bars	24	48	426	619	507	1080	1600	158,2	88,8	4,5	
		5 bars	23	45	341	508	417	810	1200				
		4 bars	22	43	255	410	336	577	1000				
MTZ 10 RV													
Air motor reference	Reduction ratio	Air supply pressure	Speed (rpm)		Torque (N.m)			Max Power (W)	Air cons (Nl/min)	Dimensions			
			@ max Power	Free	@ max Power	Max (stall)	Starting torque			A (mm)	Ø (mm)	Weight (kg)	
MTZ 10 RV 169	169	6 bars	48	96	246	316	278	1243	1600	148,7	88,8	4,6	
		5 bars	45	91	194	254	223	923	1300				
		4 bars	42	85	149	195	172	662	1000				
MTZ 10 RV 202	202	6 bars	40	81	295	379	333	1243	1600	148,7	88,8	4,6	
		5 bars	38	76	232	304	267	923	1300				
		4 bars	35	71	179	234	206	662	1000				
MTZ 10 RV 258	258	3 bars	32	63	376	483	425	1243	1600	148,7	88,8	4,6	
		2 bars	30	60	296	387	341	923	1300				
		1 bars	28	55	228	298	262	662	1000				
MTZ 10 RV 309	309	0 bars	26	53	450	578	509	1243	1600	148,7	88,8	4,6	
		1 bars	25	50	354	464	408	923	1300				
		2 bars	23	46	273	357	314	662	1000				

Data indicated in this table have an accuracy of +/- 5%

OPTIONS AVAILABLE FOR THIS MOTOR

Collected exhaust	00	01	02	03	04	05	06	07	09	10	11	12	13	14	15	16	17	18	19	21	22	23	27	28	29	30	31	32	36	37	
ATEX certification																															
Left/Right switch*																															
Lubrication free																															
Kit start																															
Speed control**																															
Stainless steel																															

* Reversible motors only ** Non reversible motors only

LAYOUT

MTZ 10 XT

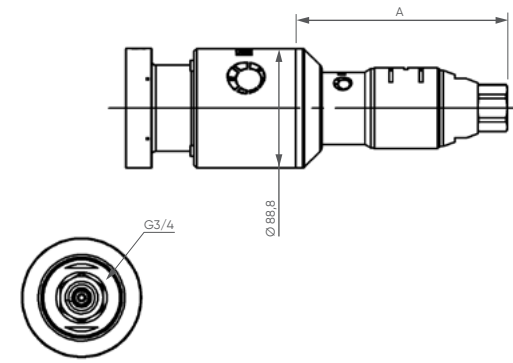

MTZ 10 RV

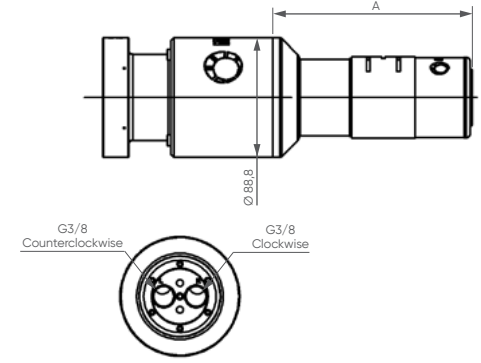

POWER, SPEED, TORQUE AND AIR CONSUMPTION GRAPHS

MTZ 10 XT

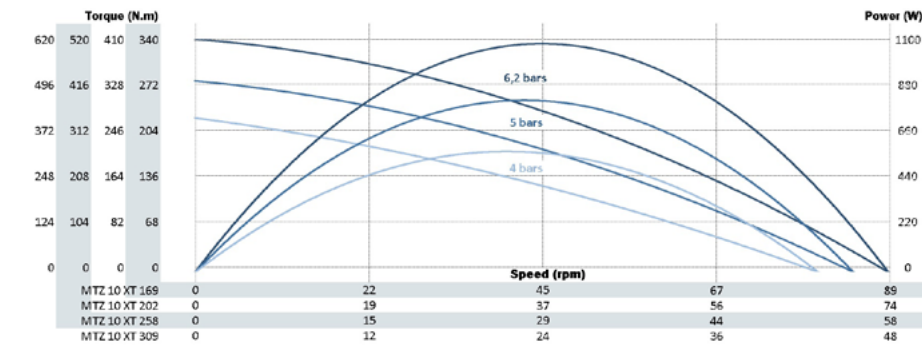

MAXIMUM RADIAL & AXIAL LOAD

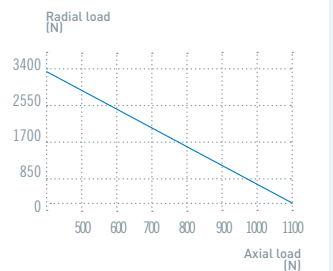

for 100 millions revolutions (load applied @ half shaft length)

NOTES

MTZ 10 RV

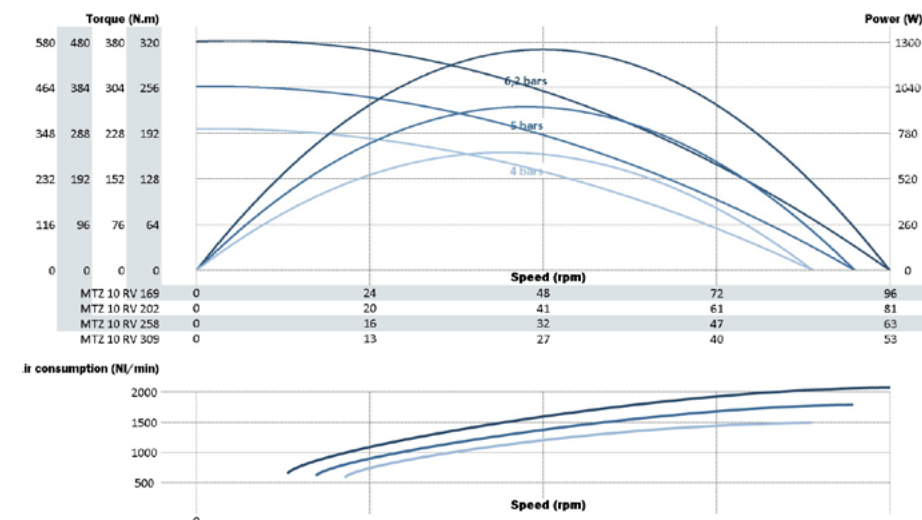

FLANGES **GROUP VI**

- XTZ 08
- XTZ 10
- XTZ 20
- XTZ 25
- XTS 30

GROUP VI FLANGE AA

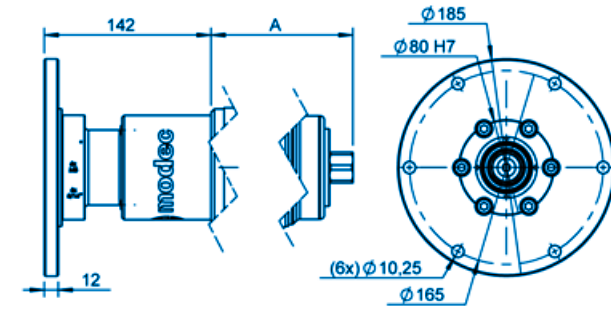

GROUP VI FLANGE AB - IEC80B14

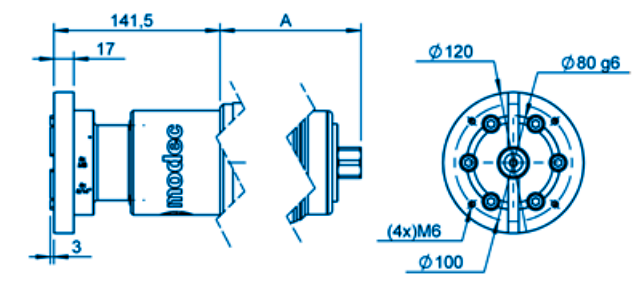

GROUP VI FLANGE AG - IEC80B5

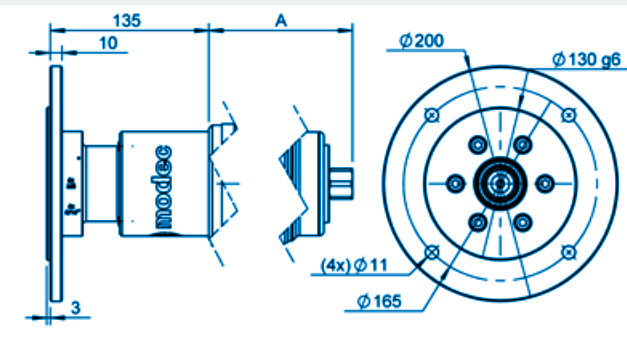

GROUP VI FLANGE AI WITH SHAFT CNW

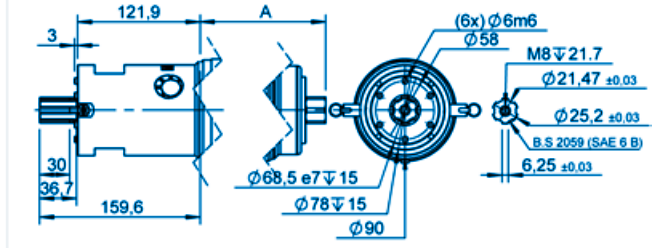

GROUP VI FLANGE AL

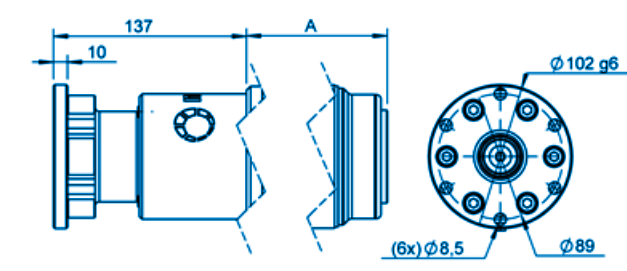

GROUP VI FLANGE B

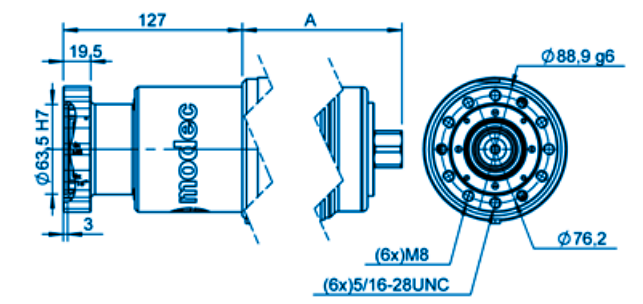

GROUP VI FLANGE H

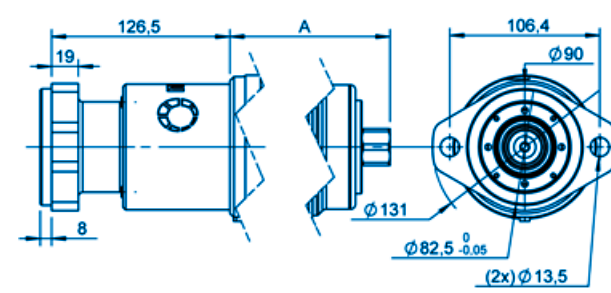

You didn't find your match ?

Contact us !

SHAFTS **GROUP VI**

- XTZ 08
- XTZ 10
- XTZ 20
- XTZ 25
- XTS 30

GROUP VI SHAFT 003 - KEYED Ø19 - IEC 80B14 - IEC 80B5

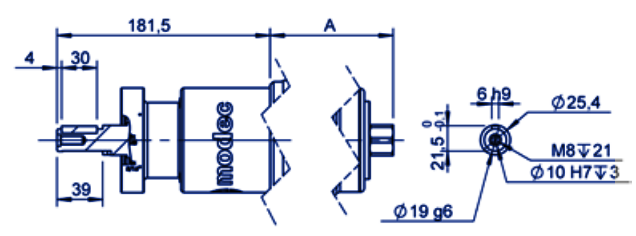

GROUP VI SHAFT CA1 - SQUARE 3/4"

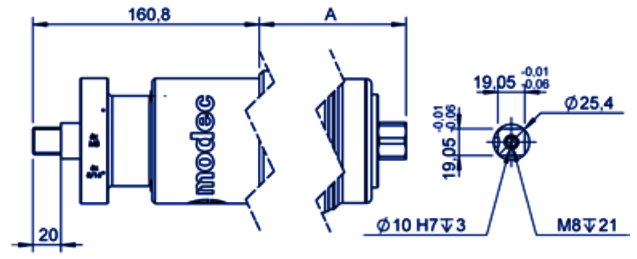

GROUP VI SHAFT CL2 - KEYED Ø1"

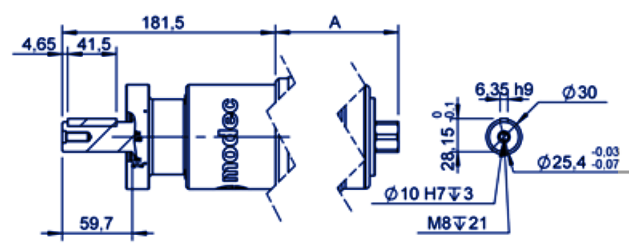

GROUP VI SHAFT CL4 - KEYED Ø25

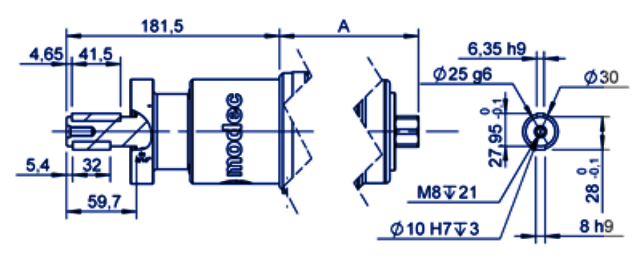

You didn't find your match ?

Contact us !